KIT PART NUMBER 6730033
INSTRUCTIONS FOR HOT WATER TANK

CHECK THE PARTS RECEIVED IN THE KIT WITH THE PARTS LIST IN THESE INSTRUCTIONS. IF ANY PARTS ARE MISSING, CONTACT THE NATIONAL VENDORS PARTS DEPARTMENT IMMEDIATELY.

**Read these instructions carefully before installing the kit.
Keep these instructions for part numbers and for future reference.**

THIS KIT CONTAINS THE FOLLOWING :

PART NUMBER	DESCRIPTION	QUANTITY
1172021	NUT-1/4-20 WHIZ-LOCK	4
1141046	10-32X1/2 ACORN HWHO-WIBS	4
3103098	PLASTIC COMPT TUBING	68
6238045	PLUG ASSY-HOT WATER VALVE	1
6539003	JUMPER-SAFETY (633 TO PRESENT)	1
6539004	JUMPER-SAFETY (FOUND MAINLY ON 623)	1
6739000	SAFETYSTAT ASSEMBLY	1
6730034	INSTRUCTIONS-TANK CONV. KIT	1
6408120	"O" RING-.25 ID	1
6530026	TEMPLATE-LID CENTER HOLE	1
6738015	WELD ASSY-H.W.T. HDC 2	1
6738032	GASKET-CONTINUOUS-HDC 2	1
6738033	COVER-FRONT WATER TANK	1
6738046	RETAINER-PLUG HWT	3
6238138	INSUL-BACK-HOT WATER TANK	1
6338022	INSULATION-WATER HEATER	1

TO REMOVE THE HOT WATER TANK:

1. Using the drain hose, completely drain the water tank.
2. Remove all product canisters, product chutes, grinders, and the cup station.
3. Remove all the hoses from the product water valves.
4. Remove the water valve cover.
5. Remove the inlet water hose from the top of the tank.

-
6. Remove the water overflow hose from the bottom of the water tank.
 7. Remove the hose clamp that is found at the Y that is in between the spray hose and the drain hose. Separate the drain hose from the spray hose. As shown in figure 1.
 8. Remove the heater cover at the bottom of the water tank.
 9. Remove the wiring harness connected to the water valves, heater, float switches, heater safety stat. and temperature sensor.

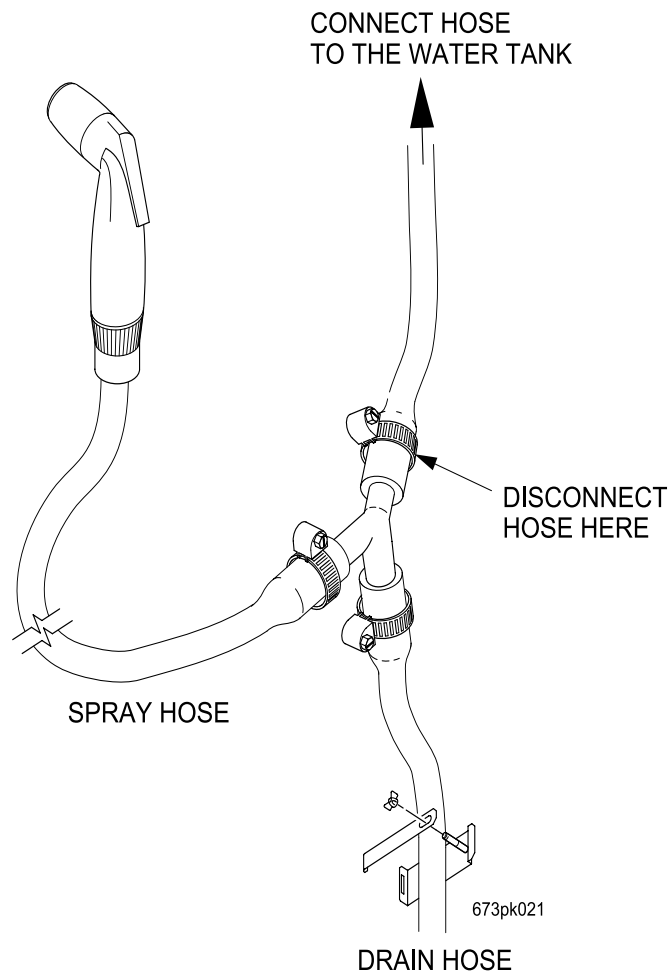
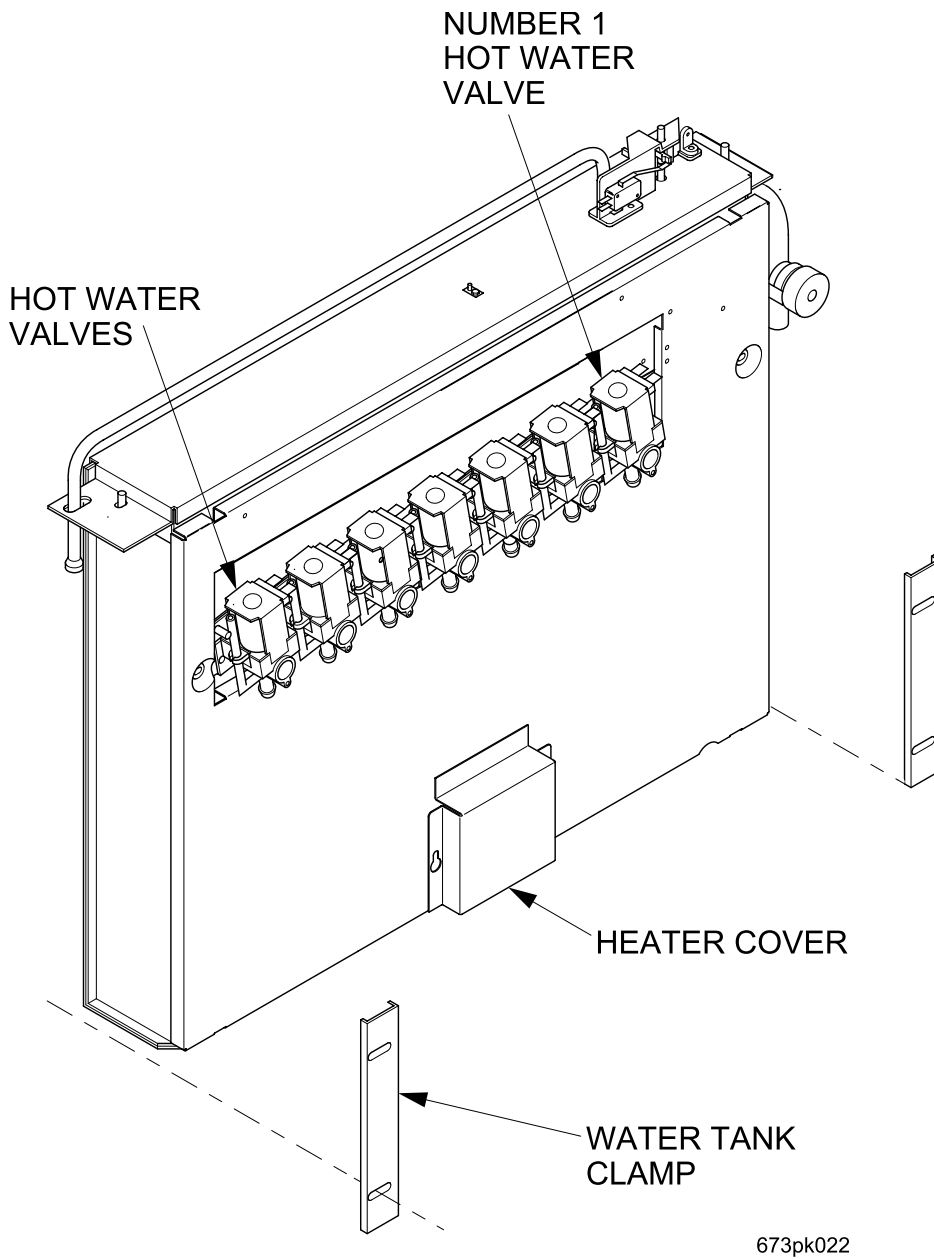

Figure 1



673pk022

Figure 2

10. Remove the two mounting screws found on each side of the water tank securing the water tank to the cabinet of the machine and the two mounting brackets (discard screws and mounting brackets).
11. Remove the water tank and the insulation that is found behind the water tank.

PREPARE THE NEW HOT WATER TANK FOR INSTALLATION:

12. Remove the hot water valves, valve plugs, heater element, temperature sensor bracket, temperature sensor, and drain hose from the original hot water tank.
13. Remove the lid assembly from the original hot water tank (save the lid assembly for use on the new hot water tank).
14. Install all of the water valves except the number one hot water valve and the heater element to the new water tank. We strongly recommend that you replace the heater element gasket and O-rings on each water valve. If you are using older National water valves, you need to place the O-ring in the first position as shown in figure 3. Note: If plugs are being used in place of the water valve, you must secure them using the plug brackets (part #6738046).As shown in figure 4.

15. Remove the float and switch assemblies from your old water tank lid.

16. Place the paper drilling template provided on the original water tank lid part # 6530026.

17. Drill a hole in the center of the tank lid as indicated on the template.

18. Re-assemble the float and switches to the tank lid assembly.

19. Install tank lid gasket to the new water tank.

20. Install the tank lid to the new water tank. The “O” ring needs to be placed on the center stud under the nut.

21. Install drain hose on bottom of the water tank.

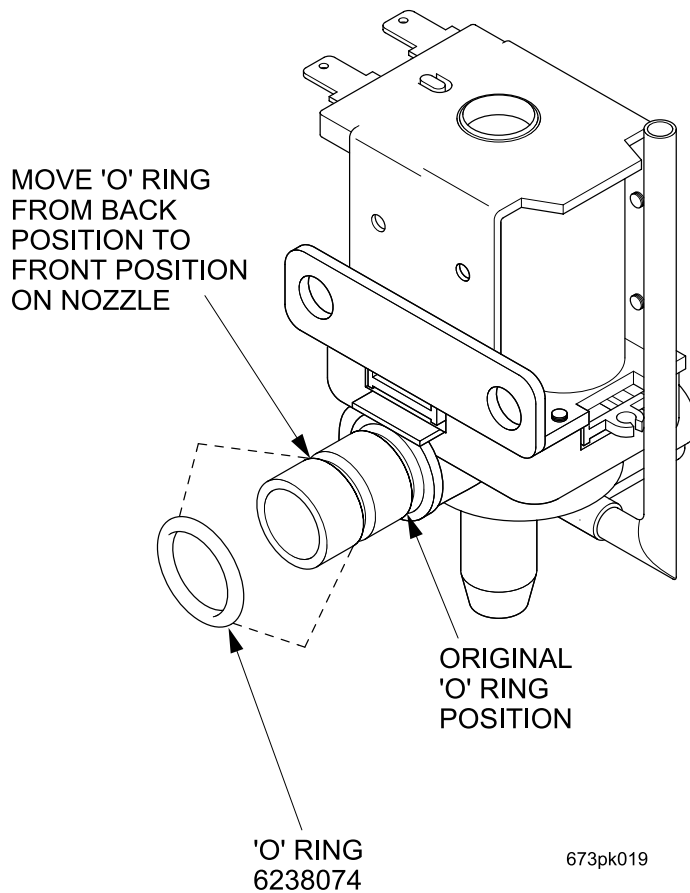

Figure 3

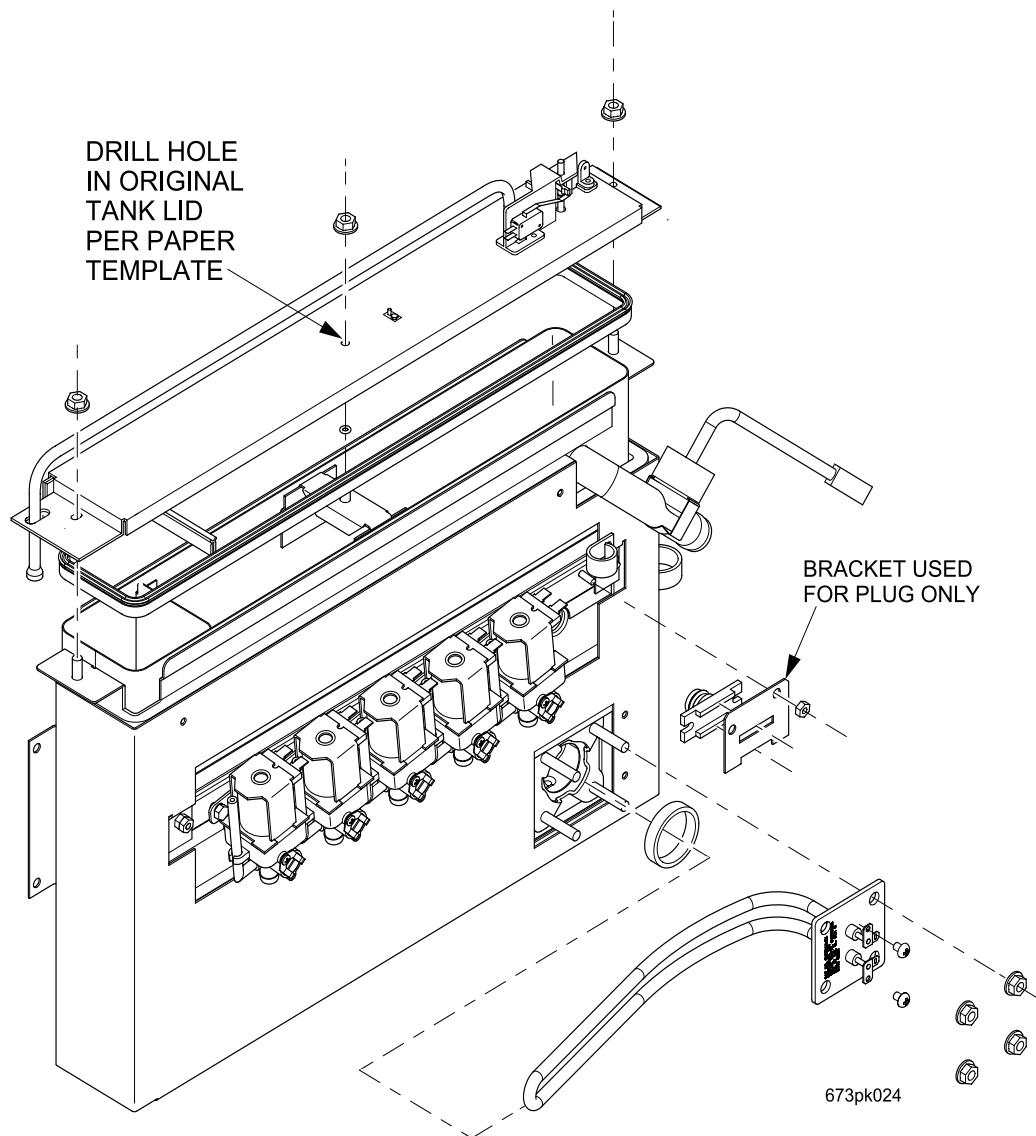

Figure 4

INSTALL HOT WATER TANK.

22. Set rear insulation in place before installing the water tank in machine. You may need to use tape to hold the insulation in place until the tank is mounted.
23. Mount the new water tank in the machine using the four screws that are in the kit part #1141046.
24. Insert the temperature sensor into the dry well of the water tank located next to the number one water valve.
25. Using the existing machine harness, connect the temperature sensor, heater, and the float switches.

-
26. Using the jumper wire, plug the existing harness into the jumper and plug the other side of the jumper into the safety stat.. If your safety stat. has spade connectors you will need to use jumper #6539004 if not use, #6539003.
 27. Replace the heater and safety stat. covers.
 28. Install number one water valve.
 29. Connect all of water valves using the existing harness.
 30. Connect hoses to water valves and the hose.
 31. Connect spray hose to tank using hose clamp.
 32. Connect the inlet water hose to the top of the water tank. The hose may need to be cut to size in order to remove excess slack.
 33. Replace the water valve cover.
 34. Replace all canisters, product chutes, grinders and the cup station.